

STI AED PROTECTIVE CABINETS

Clear Polycarbonate Cabinets Help Protect Against Vandalism and Environmental Conditions

Multipurpose cabinets for remote AED (Automated External Defibrillator) units, which require physical or environmental protection. Helps guard against vandalism (accidental or intentional), as well as dirt, dust and grime. Cabinets mount on the wall enabling the unit to be stored in a central location. The cabinets are available with a thumb lock, which helps deter wrongful users from the unit and has an additional eyelet for a secondary safety seal.

How It Works

Cabinets are constructed of clear polycarbonate which allows the unit within to be highly visible from any angle. When the cabinet is opened the optional alarm emits an ear piercing siren. The Select-Alert is a combination of alarm and super bright flashing LEDs (shown above). It offers independent strobe and siren timing of 15 seconds, 30 seconds, 60 seconds or continuous. The stop sign alarm (shown right) emits for 30 seconds, 3 minutes or continuously (as preset by user). A key override will silence the alarm.



STI-7535AED



STI-7553AED

Features

- Clear polycarbonate cover.
- Cabinet is available without alarm, with stop sign alarm or Select-Alert alarm/strobe.
- Cover includes a coated steel internal mounting plate with a baked on white enamel finish.
- Additional eyelet can be used for secondary safety seal.
- Tamperproof mounting screws available.
- External mounting tabs or internal drill dimples.
- Complete with mounting hardware and gasket.
- Design allows visibility at any angle.
- Includes thumb lock and wire shelf.
- Lifetime guarantee against breakage of polycarbonate with normal use (one year on electronics).

STI-7533AED and STI-7553AED Series

- Stop sign alarm may be set for piercing 105 dB warning horn or softer 95 dB.
- Alarm can be set to sound for 30 seconds, 3 minutes or indefinitely (unless disarmed with key supplied or until battery is drained).
- Includes a 9 VDC alkaline battery.

STI-7535AED and STI-7555AED Series

- Select-Alert is a combination of alarm and super bright flashing LEDs.
- Independent strobe and siren timing of 15 seconds, 30 seconds, 60 seconds or continuous.
- Siren offers 32 tones (see STI-SA5000 for complete alarm details).
- Alarm has a low battery indicator and is powered by a 9 VDC alkaline battery (not included) or external 12-13 volts.



Safety Technology International, Inc.
2306 Airport Road • Waterford, Michigan 48327-1209
Phone: 248-673-9898 • Fax: 248-673-1246
Toll Free: 800-888-4STI • E-mail: info@sti-usa.com
Web: www.sti-usa.com

Safety Technology International (Europe) Ltd.
Unit 49G Pipers Road • Park Farm Industrial Estate • Redditch
Worcestershire • B98 0HU • England • Tel: 44 (0) 1527 520 999
Fax: 44 (0) 1527 501 999 • Freephone: 0800 085 1678 (UK only)
E-mail: info@sti-europe.com • Web: www.sti-europe.com

STI AED PROTECTIVE CABINETS

Dimensions and Technical Information

Models Available

STI-7531AED*	Polycarbonate cover with backplate, wire shelf and thumb lock
STI-7551AED*	Polycarbonate cover with backplate, wire shelf and thumb lock
STI-7533AED	Polycarbonate cover with backplate, wire shelf, thumb lock and stop sign alarm
STI-7553AED	Polycarbonate cover with backplate, wire shelf, thumb lock and stop sign alarm
STI-7535AED	Polycarbonate cover with backplate, wire shelf, thumb lock and Select-Alert alarm
STI-7555AED	Polycarbonate cover with backplate, wire shelf, thumb lock and Select-Alert alarm
SUB-65	Optional breakaway ties (5 included)
07530WR	Wire shelf for STI-7530 series (included)
07550WR	Wire shelf for STI-7550 series (included)
07551WR	Wire oxygen rack for STI-7550 series (included with STI-7551, STI-7553, STI-7555)

* Models with no alarm

NOTE: End user must verify the alarm and battery every six months and replace battery annually or as required.

	A	B	C	D	E
STI-7531AED	12.2 in.(310mm)	14.2 in.(360mm)	6.44 in.(164mm)	16.5 in.(419mm)	N/A
STI-7551AED	19.75 in.(502mm)	24.75 in.(629mm)	7.31 in.(186mm)	23.5 in.(597mm)	N/A
STI-7533AED	12.2 in.(310mm)	14.2 in.(360mm)	6.44 in.(164mm)	16.5 in.(419mm)	23 in.(584mm)
STI-7553AED	19.75 in.(502mm)	24.75 in.(629mm)	7.31 in.(186mm)	23.5 in.(597mm)	27.5 in.(699mm)
STI-7535AED	12.2 in.(310mm)	14.2 in.(360mm)	6.44 in.(164mm)	16.5 in.(419mm)	23.5 in.(597mm)
STI-7555AED	19.75 in.(502mm)	24.75 in.(629mm)	7.31 in.(186mm)	23.5 in.(597mm)	33.75 in.(857mm)

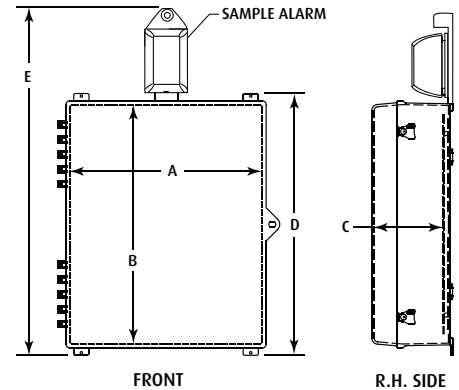

STI-7531AED* STI-7533AED STI-7535AED

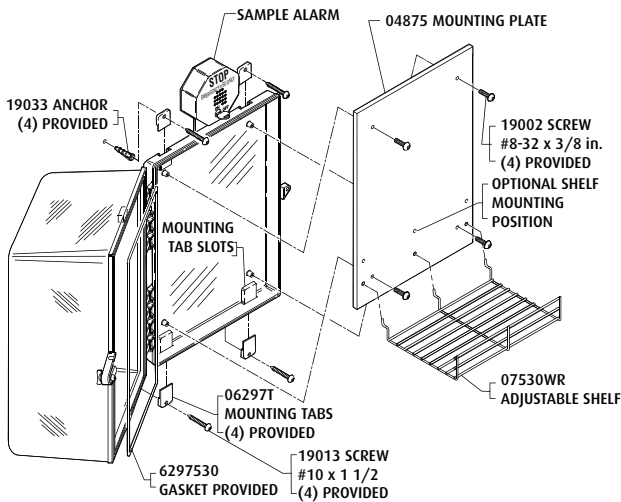

EXAMPLE OF STOP SIGN ALARM MOUNTING

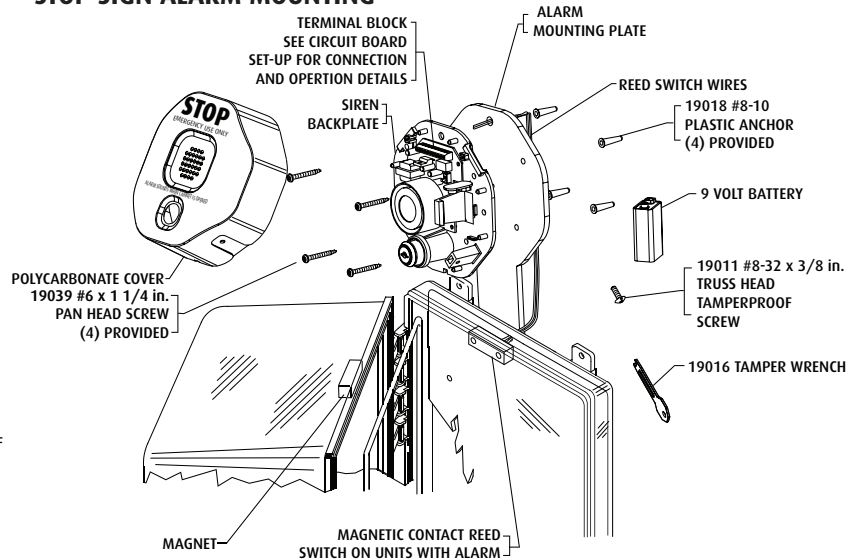

SELECT-ALERT ALARM/STROBE

STI-7551AED* STI-7553AED STI-7555AED

