

Detex Corporation, 302 Detex Drive, New Braunfels, Texas 78130-3045  
(830)629-2900 / 1-800-729-3839 / Fax (830)620-6711  
E-MAIL: detex@detex.com INTERNET: www.detex.com

## INSTALLATION INSTRUCTIONS FOR THE EAX-500 EXIT ALARM

### PATENT PENDING

### Parts breakdown depiction

(Mortise cylinder required)

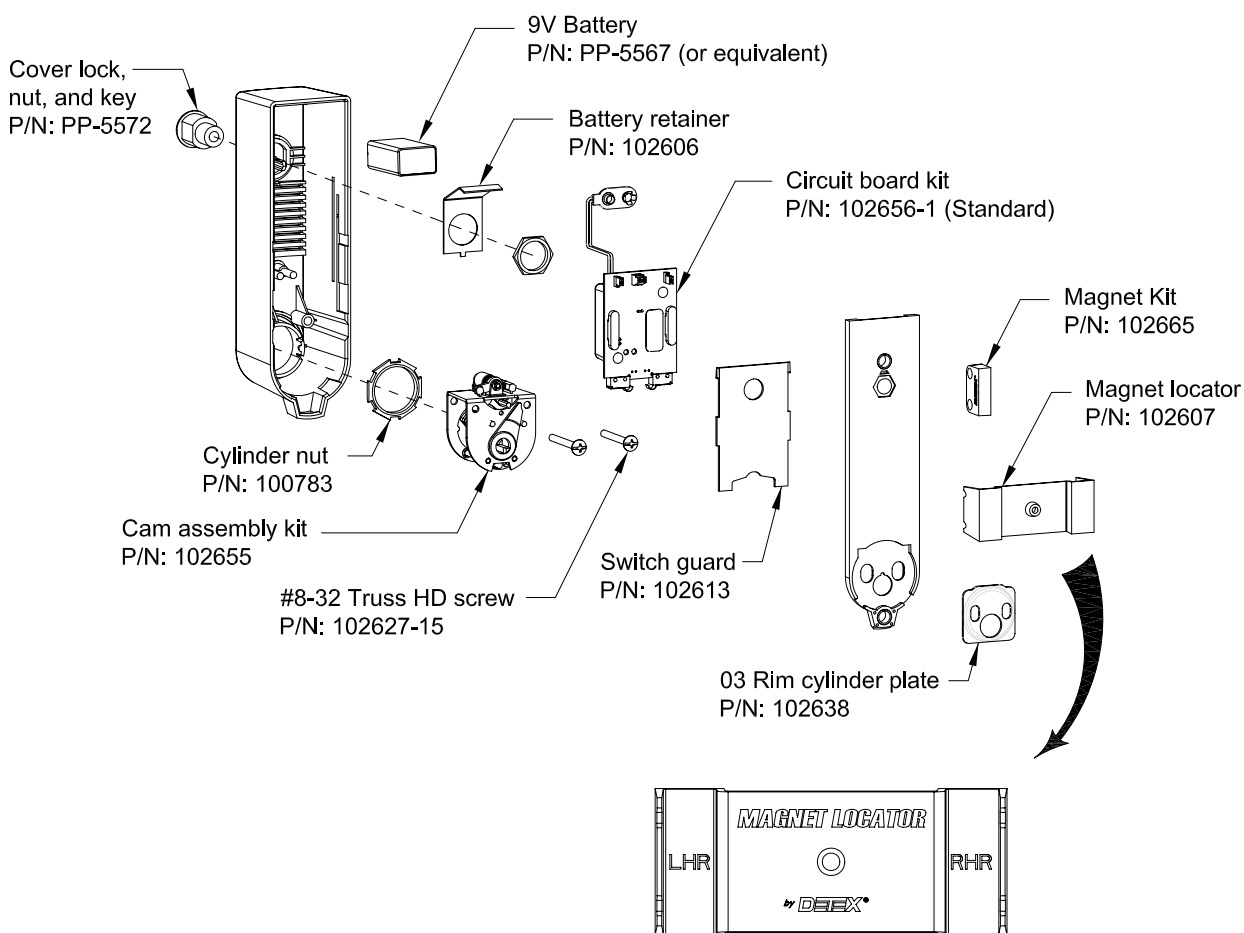

**Locate this component for Step 6**

STEPS 1-5: PREP DEVICE

1 Remove cam assembly from cover

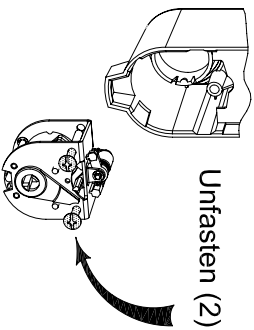

Unfasten (2) screws

2 Install mortise cylinder with cylinder nut provided

NOTE: For "Key Stop", See Figure 2

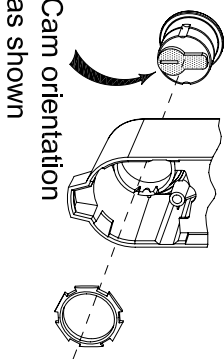

Mortise cylinder NOT provided

Cam orientation

7-pin cylinders ONLY

Collar required if distance is greater than 5/16".  
Optional collar can be ordered from Detex (p/n: ECL-1595)

3 Re-install cam assembly

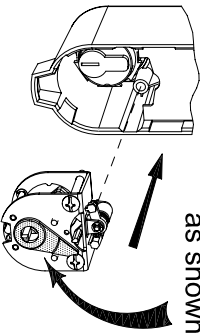

Set cam position as shown

4 Set selector switch functions (See Table A)

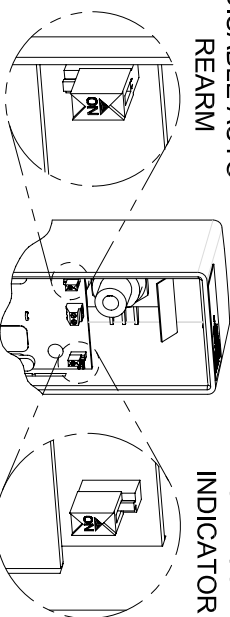

DISABLE AUTO REARM

STATUS INDICATOR

STATUS INDICATOR

5 Connect 9-volt battery and install as shown

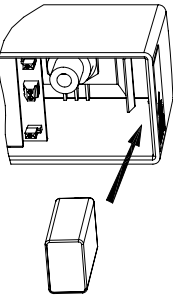

CORRECT

WRONG

STEP 6: PREP DOOR

6 Mark/drill backplate and magnet holes on door and frame/mullion

NOTE: Remove locator and backplate prior to drilling mounting holes

Backplate

Drill #7 for #1/4-20 machine screws

Drill 7/32" or 3/16" for #14 sheetmetal screws

Magnet

Drill #43 for #4-40 machine screws

Drill #44 for #4 sheetmetal screws

OKC

Where applicable, mark TOP hole center & drill 1/4" dia. pilot hole through door

See OKC INSTALLATION

Backplate

LHR installation shown for reference only

Drill #7 for #1/4-20 machine screws

Drill 7/32" or 3/16" for #14 sheetmetal screws

FRAME/MULLION

DOOR

STEP 7: INSTALL DEVICE

7 Install magnet, backplate and cover

Install magnet with (2) #4-40 or #4 screws

Install magnet with (2) #1/4-20 or #14 screws

Hook at bottom, then lift cover over backplate

Turn key CW to lock cover

OKC INSTALLATION

IMPORTANT!

Cylinder Side:

Drill 1-1/4" hole through outside door face

1-1/4" Dia

Device Side:

Drill 1-3/8" hole through inside door face

1-3/8" Dia

3/4"

DOOR

TAILPIECE

DOOR

PROVIDED

ASSEMBLE

MULTI-DOOR FUNCTION (Recommended installation)

Flex walls outward to remove guard & board

Recommended hole size

1-1/2"

1"

Drill 7/8 dia (1) place

Fitting or nut NOT included P/N: PP-5107

Diagram shown typical for two door magnetic switches

Diagram shown typical for two door magnetic switches

Closed

C

Mag Switch 1

Closed

C

Mag Switch 2

Terminal

Table A: Selector Switch Functions	
STATUS INDICATOR	STATUS DESCRIPTION
OFF*	No indication that device is armed or disarmed.
ON	ARMED - red LED blinks approximately every 15 seconds. ** DISARMED - green LED blinks approximately every 15 seconds. **
DISABLE AUTO REARM	STATUS DESCRIPTION
OFF	DEFAULT: Alarm will automatically rearm 2 minutes after alarm has been activated and door closed. Custom settings can be programmed by DETEX.
ON*	Alarm will not automatically rearm after alarm has been activated.

\*Default settings; \*\*Will shorten battery life

Screw wires to (P1) terminal block (18ga Max wire dia)

Cut (JP1) jumper

NOTES:

1. If wire runs longer than 10 feet, must use twisted pair

2. 1/16" slotted jeweler screw driver required.

3. If internal contact is used DO NOT cut jumper (JP1)

# EAX-500 Operations

Ins No: 101321

NOTE: Depending on models ordered, delay times may vary

## SPECIAL NOTES and DEFINITIONS

1. The door needs to be closed to test the unit.
2. When operating the ON/OFF switch, there is a slight delay.
3. The key is inserted and removed only in the vertical position (home position).
4. Key function: counter clockwise (CCW) = Armed; clockwise (CW) = Disarmed
5. The battery needs to be disconnected to register changes in the slide switches.
  - a. Status Indicator (This will affect battery life)
  - b. Disable Auto Rearm

## MAGNET TRAINING-RECOGNITION

1. Install battery, unit chirps once (place unit on door).
2. With door open, turn key CCW - red LED flashes twice.
3. Turn key CW to disable alarm.
4. Close door - green LED flashes once
5. Unit has correctly recognized magnet placement.

## UNIT ARMING TEST:

1. Turn key counterclockwise (CCW) (key is removable after rotating back to vertical position)
2. Red LED will flash twice, then green LED will illuminate for the 1, 5, or 15 second delay time (depending on model ordered), then turn off. The siren will sound three short beeps indicating the unit is armed.
3. Open door (Siren will sound and red LED will illuminate)
4. Turn key clockwise (CW). Turns alarm off.

## LOW BATTERY ALERT:

1. Siren will beep and red LED will blink at approximately 45 second intervals when battery is low

## STATUS INDICATOR

1. Slide the switch to ON and then, install battery.
2. If the unit is armed, the red LED will blink every 15 seconds.
3. If the unit is disarmed, the green LED will blink every 15 seconds.

## Disable AUTO REARM

1. Slide switch to OFF and then, install battery.
2. Unit arms as described above (see Unit Arming Test)
3. Once the unit is in full alarm and the door closes, the alarm will shut off after 2 minutes.

**Figure 1**  
Key orientation

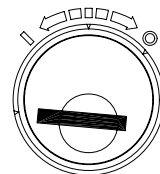

"ON"  
position

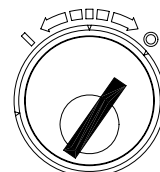

"OFF"  
position

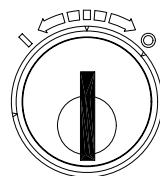

"ON"  
position  
(If Key  
Stop  
installed)

NOTE: Key Stop will prevent key removal in "OFF" position

**Figure 2: KEY STOP INSTALLATION**  
(Key stop included in hardware kit)

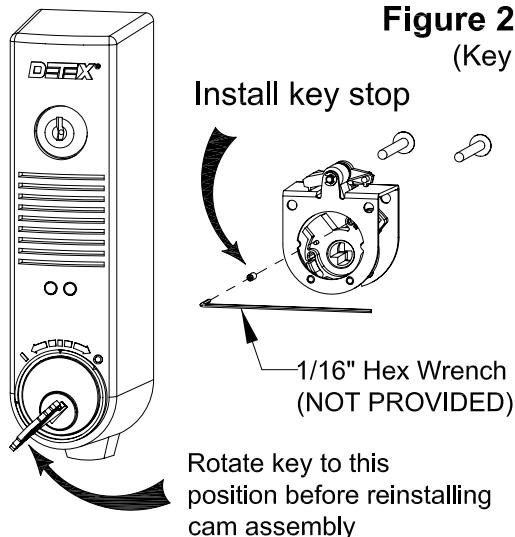

Top surface of Key Stop should **NOT** protrude beyond highest point on plastic cam

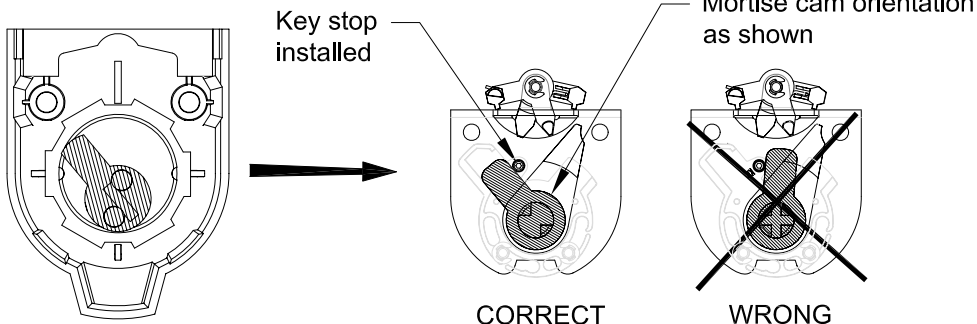
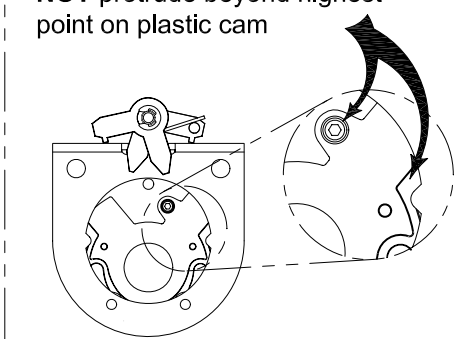

Cam orientation  
for Key Stop option

**Back View**

**Front View**  
KEY STOP POSITIONS

"ON" position  
(Key can be removed)

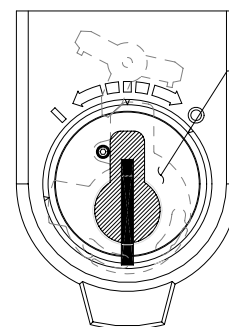

Key and cams  
shown in 90°  
stop "ON"  
position

"OFF" position  
(Key cannot be removed)

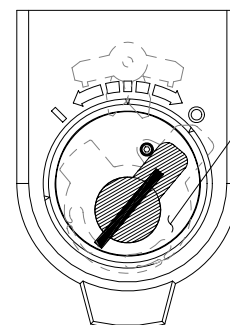

Key and cams  
shown in "OFF"  
position